



Jayco

Generations of family fun.

PINNACLE

FIFTH WHEELS



32RLTS

Ext. Lgth: 36' 4" Weight: 12,810 lbs. Hitch: 2,540 lbs.

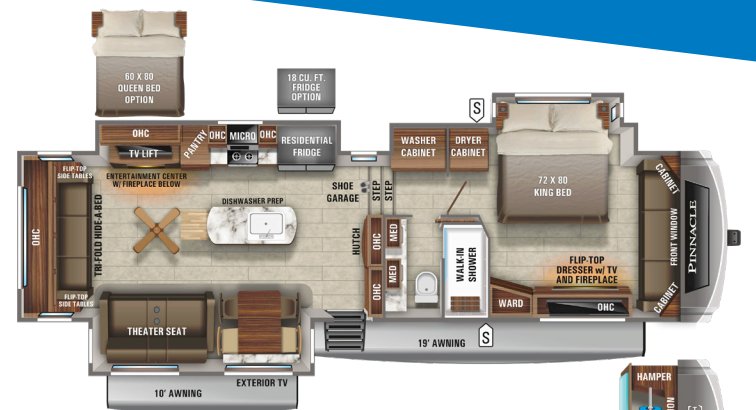

36SSWS

Ext. Lgth: 40' 0" Weight: 14,105 lbs. Hitch: 3,270 lbs.

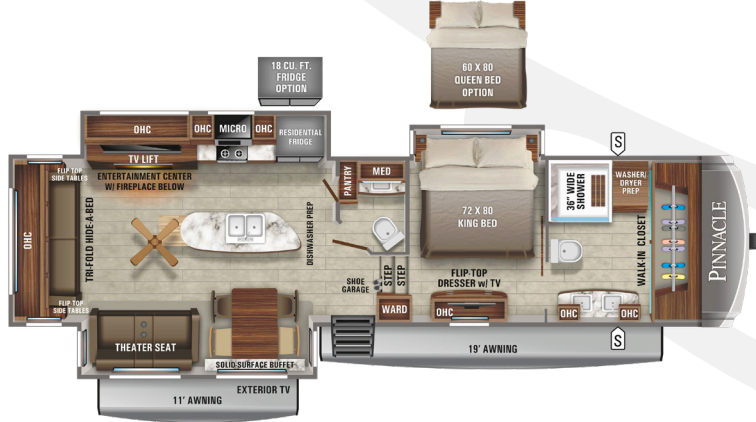

36FBTS

Ext. Lgth: 40' 10" Weight: 13,635 lbs. Hitch: 2,940 lbs.

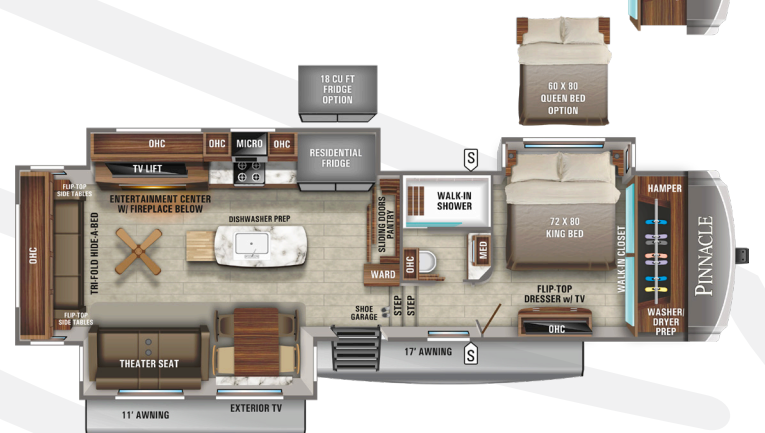

36KPTS

Ext. Lgth: 41' 1" Weight: 13,540 lbs. Hitch: 2,920 lbs.

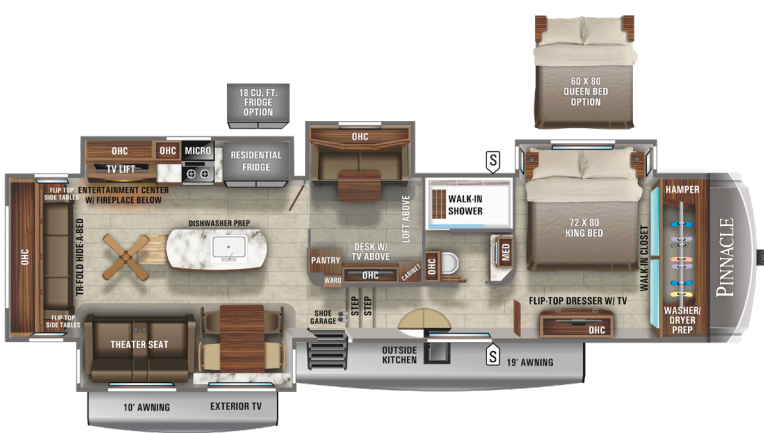

37MDQS

Ext. Lgth: 41' 8" Weight: 14,445 lbs. Hitch: 3,370 lbs.



38FLGS

Ext. Lgth: 44' 5" Weight: TBD Hitch: TBD

STANDARDS & OPTIONS

STANDARD EXTERIOR EQUIPMENT

Stronghold VB^{LM} aluminum framed and vacuum bond laminated gelcoated fiberglass exterior walls (including rear wall and slide room end walls)

Magnum TrussTM XL6TM Roof System (strongest tested roof in the industry) with one piece, seamless DiFlex II material

Climate ShieldTM zero-degree tested weather protection:

- Fully enclosed and heated underbelly (ducted)
- 40,000 BTU output furnace
- Double layer fiberglass batt insulation (roof, floor, and slide room floors)
- PEX plumbing

HELIX Cooling SystemTM (industry exclusive):

- Dual exterior-mounted 15,000 BTU "Whisper Quiet" A/C units
- Jayco exclusive insulated dual duct design
- Directional and closeable A/C vents
- Larger return air vents with use accessible filters

JaySMARTTM (Safety Markers And Reverse Travel) LED lighting (patent-pending)

Painted fiberglass front and rear cap with built-in specialty LED lighting

Frameless dark tinted safety-glass windows

Custom automotive-grade vinyl exterior graphics package

Skirt metal enclosed drop frame

LED exterior lighting package

Dual 30 lb. propane bottles with auto regulator

Doorside compartment framed and vented for third propane bottle

Pass-through storage with Slam-latchTM baggage doors

Digital TV antenna with Wi-Fi extender

Exterior marine-grade speakers

Fully enclosed, LED-lit universal docking center:

- Selectable water connections
- Quick-connect outside shower
- Black tank flush
- Winterization and sanitation
- Independent satellite and whole coach cable hookups

Water heater bypass

Battery disconnect

Under-mounted spare tire (Goodyear[®] Endurance[®] tires-made in the USA)

LP quick-connect (outside grill prep)

Roof ladder

Equalizer Systems Hydraulic 6-point auto-leveling system with oversized foot pads

STANDARD INTERIOR EQUIPMENT

Solid hardwood doors, drawers, stiles and slide fascia

Handcrafted hardwood glazed doors, drawers and trim

5/8 in. tongue-and-groove joined plywood floor decking

Vinyl flooring (made in the USA) throughout (including slide rooms)

Ceiling fan (select models)

LED interior lighting throughout

LED accent lighting above slideouts

Tri-fold hide-a-bed sofa with residential sleep surface (select models)

Dual USB charging ports throughout

12V charging station

"Shoe garage" in hallway step (select models)

Flip-up table top storage next to tri-fold sofa (select models)

Positive catch, heavy-duty, 75 lb. full extension, steel ball-bearing drawer guides

Toe kick night lights in bedroom, bathroom and kitchen

Stainless steel kitchen sink

Residential-grade, pull-out kitchen faucet

21 cu. ft. residential refrigerator and 1,200W pure sine wave inverter

Under-mounted stainless steel bathroom sink

Extra 120V power outlets in kitchen and slide rooms

Dishwasher prep in kitchen

Pull-out countertop extension with 24 in. x 24 in. butcher block bar top (industry first)

Pull-out utility drawer under kitchen sink

Residential quilted bedspread and pillows

Gas-strutted under-bed storage

C.P.A.P. prepped bedroom

Carbon monoxide and LP detector

Flip-up hidden storage in bedroom chest of drawers

Built-in laundry hamper in wardrobe

Cup holders in bedroom nightstands

Bathroom skylight

Medicine cabinet with mirror and LED lighting above

Bathroom multi-metal tile backsplash

Porcelain toilet with foot flush

CUSTOMER VALUE PACKAGE (MANDATORY)

MORryde[®] StepAbove[™] entrance steps (main entrance)

15,000 BTU "Whisper Quiet" A/C (Living room)

10 gal. gas/electric DSI water heater

Custom machined aluminum rims

Keyed-Alike[™] lock system (single key for all doors/locks)

Rooftop and ground solar prep by Go Power![®]

Backup and side observation camera prep

XL grab handle

Hidden hinges on cabinet doors

15,000 BTU "Whisper Quiet" A/C (Living room)

JBL[®] home entertainment system

LED HDTV with fully digital HDMI[®] output

Wireless remote control system (includes Bluetooth[®] wireless interior controls)

Residential king (72 in. x 80 in.) Serta[®] mattress with under-bed storage

5 STAR HANDLING PACKAGE (MANDATORY)

Goodyear[®] Endurance[®] tires (made in the USA)

MORryde[®] pin box

Dexter[®] axles with Nev-R-Adjust[®] brakes, E-Z Lube[®] hubs, & 4,000 lb. leaf springs

MORryde[®] LRE-4000[™] rubberized suspension

Wet bolt fasteners and bronze bushings

LUXURY PACKAGE (MANDATORY)

2nd electric patio awning with integrated LED lights

Powered 50-amp cord reel

JAYCOMMAND[™] "Smart RV" system

Cellular prep for antenna and JAYCOMMAND[™] "Smart RV" system

Tire Pressure Monitoring System (TPMS)

High gloss gelcoated sidewalls

Oversized multi-battery compartment (industry leading room for 4-6 batteries)

32 in. LED outside TV

Hardwood cabinet stiles

Central vacuum system

Day/night roller shades in living room

Free-standing (no pedestal) table with leaf, 2 free-standing (with under seat storage) and (2) folding chairs

Whole coach water purification system (includes filter)

LED fireplace with 5,000 BTU electric space heater

Drinking Water System[™] (patent-pending)

21 cu. ft. residential refrigerator and 1200W pure sine wave inverter

Dishwasher prep

Convection microwave

Residential 24 in. Insignia[™] stove (3.73 cu. ft. with 12V BTU high output burner)

Solid-surface kitchen countertop with solid-surface sink covers

2nd 15,000 BTU "Whisper Quiet" A/C in bedroom

Washer/dryer prep

OPTIONS

Canadian Standards (CSA)

Custom contemporary or traditional interior design (industry first)

Extreme Weather Package: 110V heated holding tank pads, 12V wrapped and heated fresh water line, and interior illuminated switch

Truma on demand hot water system

Customer Value Package with 15,000 BTU central air with heat pump

Full body paint- Sand, Steel or Diamond

Overlander Solar Kit (solar controller and roof-mounted 190W panel)

Wireless backup/rear and side view observation camera kit

Sani-Con[®] Turbo waste management system

Generator prep with 120 lb. max LP system includes (3) 40lb. LP bottles

5,500W Onan[®] Microquiet generator

Frameless dual-pane tinted safety-glass windows

Slideout awning (quantity varies by model)

2 in. accessory receiver hitch

Hydraulic disc brake package

3rd 15,000 BTU A/C in living area

18 cu. ft. 2-way gas/electric refrigerator with ice maker

Serta[®] queen residential foam-top mattress

2nd 190W solar panel

Front wardrobe in place of front windshield and sofa lounge (36SSWS)

FLOORPLAN	EXTERIOR TRAVEL LENGTH	EXTERIOR WIDTH	EXTERIOR HEIGHT (WITH A/C)	INTERIOR HEIGHT	INTERIOR HEIGHT BEDROOM	UNLOADED VEHICLE WEIGHT	DRY HITCH WEIGHT	GVWR	CARGO CARRYING CAPACITY	FRESH WATER CAPACITY (INCLUDING WATER HEATER)	GRAY WASTE WATER CAPACITY	BLACK WASTE WATER CAPACITY	SLEEPING CAPACITY
32RLTS	36' 4"	8' 6"	12' 8"	8' 6"	6' 7"	12,810	2,540	15,500	2,690	85	87**	50	3-4
36SSWS	39' 11"	8' 6"	13' 3"	8' 6"	6' 7"	14,105	3,270	16,750	2,645	85	87**	50	4-5
36FBTS	40' 10"	8' 6"	13' 4"	8' 6"	6' 7"	13,635	2,940	16,500	2,865	85	87**	87**	3-4
36KPTS	41 0"	8' 6"	13' 4"	8' 6"	6' 7"	13,540	2,920	16,500	2,960	85	87**	50	3-4
37MDQS	41' 8"	8' 6"	13' 4"	8' 6"	6' 7"	14,445	3,370	16,995	2,550	85	87**	50	6-8
38FLGS	44' 5"	8' 6"	TBD	8' 6"	6' 7"	TBD	TBD	TBD	TBD	85	87**	TBD	5-6

Some specs at the time of print may include estimates, for the most updated information, please visit Jayco.com

**Indicates split tanks



TRAVEL WITH CONFIDENCE • NO ONE OFFERS A BETTER WARRANTY

At Jayco, we build our RVs to handle every adventure, then back them with our industry-leading 2+3 limited warranty. Our 2-year limited warranty has you covered for 2 camping seasons. That's 730 days. In addition, our 3-year structural limited warranty has you covered for 3 camping seasons or 1,095 days. You won't find a better limited warranty in the business, because the only strings that we attach are those that deliver the ultimate in reliability. That's the Jayco difference. So go explore. For a copy of our 2-year limited + 3-year limited structural warranty with complete terms and conditions, please contact your local Jayco dealer.



Scan QR code for specification definitions



Generations of family fun.